

CITY OF NEW HAVEN
COMMUNITY SERVICE ADMINISTRATION
DEPARTMENT OF HEALTH
BUREAU OF ENVIRONMENTAL HEALTH
54 Meadow Street - 9TH Floor • New Haven • Connecticut 06519
Phone 203-946-8174 • Fax 203-946-6509

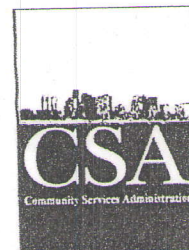

JOHN DESTEFANO, JR.
MAYOR

MARIO GARCIA, MD, MSc, MPH
DIRECTOR OF HEALTH

TO: Cathy Carbonaro-Schroeter
CC: Susmitha Attota, City Plan
Kenny Hill, Owner
FROM: Jomika Bogan
DATE: September 12, 2011
RE: **235 Winchester Avenue, New Haven, CT**

This letter is to inform you that on July 29, and September 9, 2011, Jomika Bogan, of this department conducted an inspection of the interior of the above referenced premises for the purpose of identifying any lead-based paint. This inspection was requested and is being provided to aid in the allocation of Federal funds for rehabilitation.

Attached are copies of all the lead samples generated at this address. Using a portable x-ray fluorescence spectrum analyzer (XRF), a total of **74** representative samples were taken on accessible interior surfaces of the building by Jomika Bogan. Of these **74** samples, **5** are instrument calibration checks, and **10** are above 1.0 milligrams per centimeter squared (mg/cm^2).

Toxic levels of lead in dried paint are defined as lead greater than one half of one percent (0.50%) as determined by atomic absorption spectrophotometry (or other approved laboratory method) or lead at or above one milligram per centimeter squared of surface ($\geq 1.0 \text{ mg}/\text{cm}^2$) as determined on site by XRF analysis. On metal substrates an XRF reading greater than $1.2 \text{ mg}/\text{cm}^2$ is positive while readings 1.0 - $1.2 \text{ mg}/\text{cm}^2$ (inclusive) are inconclusive, requiring a paint chip sample be collected and the lead content level confirmed by laboratory analysis; the sample may also be assumed positive in lieu of paint chip analysis. (These are performance specifications written for the RMD, Inc. LPA-1 analyzer which is used by this department.)

These samples represent similar painted surfaces on the side of the building and/or in the room equivalent (e.g., a porch, bedroom). Positive samples on a given side or room equivalent means all similar painted surfaces on that side or in the room equivalent are to be considered toxic. For example, a positive white window casing on Side B in Room 1 means all white window casings in Room 1 are positive. Generally, the walls facing the street side of the building are Side A. Moving clockwise, Side B is the next set of walls perpendicular to Side A; Side C is the next set of walls perpendicular to Side B (generally the rear of the building); and Side D is the last set of walls perpendicular to Side C (see diagram below).

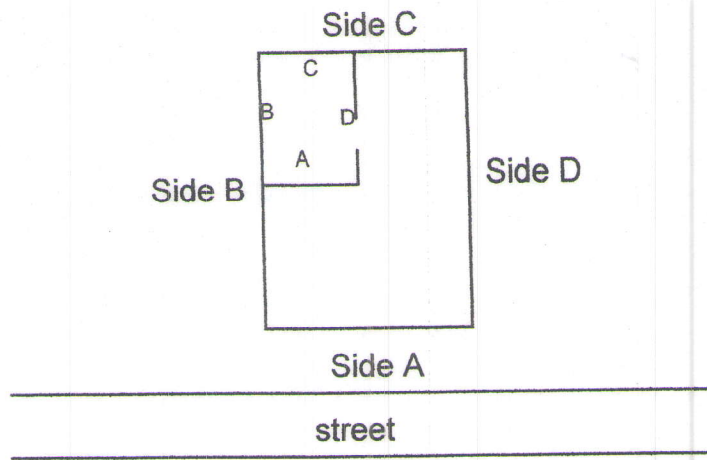

Please contact me at (203) 946-8176 with any questions regarding the report or to discuss this matter further.

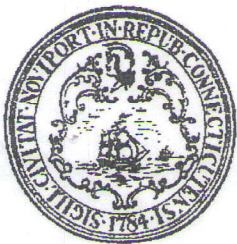

CITY OF NEW HAVEN
COMMUNITY SERVICE ADMINISTRATION
DEPARTMENT OF HEALTH
BUREAU OF ENVIRONMENTAL HEALTH
54 Meadow Street – 1ST Floor • New Haven • Connecticut 06519
Phone 203-946-8187 • Fax 203-946-7521

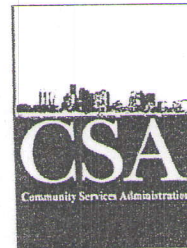

JOHN DESTEFANO, JR
MAYOR

MARIO GARCIA, MD, MSc, MPH
DIRECTOR OF HEALTH

The following locations were found to contain lead levels above 1.0 milligrams per centimeter squared (mg/cm²):

<u>Sample #</u>	<u>Location/Component</u>	<u>Quick Mode</u>
26	1F; Apt. 3L; Wall A, White	1.9
37	2F; Apt. 3L; Baseboard, Cream	2.1
41	2F; Apt. 3R; Wall A, Yellow	1.1
42	2F; Apt. 3R; Wall B, Yellow	1.3
66	Exterior, Side B, Wood Trim, Yellow	>9.9
67	Exterior, Side B, Metal Pipe, Yellow	6.6
68	Exterior, Side B, Clapboard (attached to pipe), Yellow	>9.9
70	Exterior, Side B, Moulding, Yellow	5.7
71	Exterior, Side B, Clapboard, Yellow	>9.9
73	Exterior, Side C, Clapboard, Yellow	8.7

The following areas are assumed (due to unreachable components) to contain lead levels above 1.0 milligrams per centimeter squared (mg/cm²) unless proven otherwise:

Location/Component

Exterior, Side A; Eaves, Yellow
Exterior, Side B; Eaves, Yellow
Exterior, Side C; Eaves, Yellow
Exterior, Side C; Moulding, Yellow
Exterior, Side D; Eaves, Yellow
Exterior, Side D; Moulding, Yellow
Exterior, Sides A, B, C, D; Upper, Inner Window Casings, Yellow

In addition, a paint chip (defective, yellow) sample was taken from the overhang from Side A. This paint chip was found to contain lead. Please see attached laboratory test report for result.

City of New Haven Health Department - Bureau of Environmental Health
XRF Calibration Check Data Form

Inspection Address:

235 Winchester Ave
New Haven, CT

Inspection Date:

7/29/11

Inspector:

BOGAN

XRF Model: RMD, Inc. LPA-1 Serial Number 15 87

Job Number:

072911

Time	Sample #	Substrate	Reading mg/cm2
	1	Film 1.0	0.9
	2	Wood	0.0
	3	Film 1.0	1.0
	4	Wood	0.1
	5	Film 1.0	1.0

Operating Mode:
 TC-30.

XRF is operating within specifications if average of readings on 1.0 mg/cm2 film is within range of 0.7 to 1.3 mg/cm2 inclusive.

74 shots
10 ⊕

	Film 1.0	
	Wood	
	Film 1.0	
	Wood	
	Film 1.0	

	Film 1.0	
	Wood	
	Film 1.0	
	Wood	
	Film 1.0	

	Film 1.0	
	Wood	
	Film 1.0	
	Wood	
	Film 1.0	

Inspector Signature:

[Signature]

Date:

7/29/11

City of New Haven Health Department- Bureau of Environmental Health
XRF Inspection Data Collection Form

XRF Model: LPA-1 Serial # 15

Date 7/29/11
Job # _____

Address 235 Winchester Ave
Inspector George
Room Description _____

SR = SHEET ROCK
PL = PLASTER

Sample #	Int/Ext	Side	Component	Intact/Def.	Color	Substrate	Pb mg/cm2 QuickMode
6		A	ENTER HALL	I D	cream	SR	0.2
7		B	↓	I D	↓	↓	0.2
8		C	↓	I D	↓	↓	0.2
9		D	ceiling	I D	↓	wood	0.1
10				I D	cream	wood	—
11			IF HALL	I D			0.2
12			IF-2F STAIR RISE	I D			0.2
13			IF-2F INNER STAIRWELL	I D			0.2
14			IF-2F OUTER STAIRWELL	I D			0.3
15			IF HALL DOOR LEADING TO basement) carry	I D			0.2
16			IF HALL DOOR STOP "	I D			0.1
17			IF HALL DOOR	I D			0.2
18			IF HALL DOOR	I D			0.2
19			IF HALL DOOR	I D			0.1
20			IF HALL DOOR	I D			0.2
21			IF HALL DOOR	I D			0.2
22			IF HALL DOOR	I D			0.2
23			IF HALL DOOR	I D			0.2

Total Positive this Page: 0

City of New Haven Health Department- Bureau of Environmental Health
XRF Inspection Data Collection Form

Date 7/29/11

~~2647~~
XRF Model: LPA-1 Serial # 15

Address

Inspector

Room Description

~~★~~ FIRST FLOOR ~~★~~

24	32
24	28
12	12

[illegible]

3L	3R
2L	2R
1L	1R

Date 7/29/11

Model: LPA-1 Serial # 15.

Room Description

235 Winchester Ave
Savage
* SECOND FLOOR *

[illegible]

Date _____
Job # _____

Inspector

Room Description

* Second Floor, part II *

Room Description					Pb mg/cm ²		
Sample #	Int/Ext	Side	Component	Intact/Def.	Color	Substrate	QuickMode
		-	APT 1D -	I D			
			* NO WALLS, NO WINDOWS	I D			
				I D			
		-	APT 2D -	I D	WHITE	PLASTER	0.2
40		C	WALL	I D			
				I D			
		-	APT 3D -	I D			
		A	WALL	I D	yellow	PLASTER	1.1
41		B	WALL	I D			1.3
42				I D			
				I D			
				I D			
				I D			
				I D			
				I D			
				I D			
				I D			
				I D			
				I D			
				I D			
				I D			
				I D			
				I D			
				I D			
				I D			
				I D			
				I D			
				I D			
				I D			
				I D			
				I D			
				I D			
				I D			
				I D			
				I D			
				I D			
				I D			
				I D			
				I D			
				I D			
				I D			
				I D			
				I D			
				I D			
				I D			
				I D			
				I D			
				I D			
				I D			
				I D			
				I D			
				I D			
				I D			
				I D			
				I D			
				I D			
				I D			
				I D			
				I D			
				I D			
				I D			
				I D			
				I D			
				I D			
				I D			
				I D			
				I D			
				I D			
				I D			
				I D			
				I D			
				I D			
				I D			
				I D			
				I D			
				I D			
				I D			
				I D			
				I D			
				I D			
				I D			
				I D			
				I D			
				I D			
				I D			
				I D			
				I D			
				I D			
				I D			
				I D			
				I D			
				I D			
				I D			
				I D			
				I D			
				I D			
				I D			
				I D			
				I D			
				I D			
				I D			
				I D			
				I D			
				I D			
				I D			
				I D			
				I D			
				I D			
				I D			
				I D			
				I D			
				I D			
				I D			
				I D			
				I D			
				I D			
				I D			
				I D			
				I D			
				I D			
				I D			
				I D			
				I D			
				I D			
				I D			
				I D			
				I D			
				I D			
				I D			
				I D			
				I D			
				I D			
				I D			
				I D			
				I D			
				I D			
				I D			
				I D			
				I D			
				I D			
				I D			
				I D			
				I D			
				I D			
				I D			
				I D			
				I D			
				I D			
				I D			
				I D			
				I D			
				I D			
				I D			
				I D			
				I D			
				I D			
				I D			
				I D			
				I D			
				I D			
				I D			
				I D			
				I D			
				I D			
				I D			
				I D			

Total Positive this Page:

2

XRF Model: LPA-1 Serial # 15 _____

Date 7/29/11
Job # _____

235 Winchester Ave

228

* THIRD FLOOR *

Sample #	Int/Ext	Side	Component	Intact/Def.	Color	Substrate	Pb mg./cm2 QuickMode
52		C	3E 1st FL WALL	I (D)	WHITE	PLASTER	0.3
53		B	BACK HALL WALL	I (D)	CREAM	PLASTER	0.4
54		D	* * *	I D	* *	↓	0.3
53		-	APT. 3D -	I D	WHITE	PLASTER	0.4
54		A	WALL	I (D)	CREAM	* *	0.3
54		B	WALL	I D			
51		-	APT. 2D -	I D			
58		C	WALL	I (D)	WHITE	PLASTER	0.3
			THRESHOLD INTO APT.	I D	WHITE	WOOD	0.3
				I D			
		-	APT. 1D -	I D			
			* NO WALLS, NO WINDOWS *	I D			
				I D			
		-	APT. 1L -	I D			
			* NO WALLS, NO WINDOWS *	I D			
50		-	APT. 2L -	I D	WHITE	PLASTER	0.2
50		C	WALL	I D			
60		-	APT. 3L -	I (D)	WHITE	PLASTER	0.3
61		A	WALL	I (D)	CREAM	↓	0.4
62		D	WALL	I (D)	GREEN	↓	0.3

Total Positive this Page: 1

Date 7/29/11

Inspector

Pb mg/cm²

Room Description							Pb mg/cm2
Sample #	Int/Ext	Side	Component	Intact/Def.	Color	Substrate	QuickMode
63		A	EXTERIOR (creamy yellow color)	I D	cream	wood	0.2
64			chipboard (creamy yellow color)	I D	↓	↓	0.2
65			pick-up	I D	↓	concrete	0.5
66			five layers	I D	↓	wood	ASSUME
67		B	wood trim	I D	cream	wood	>9.9
68			metal pipe (the capped-off one)	I D	↓	metal	60.46
69			chipboard attached to middle pipe	I D	black	metal	>9.9
70			five layers	I D	yellow	wood	0.2
71			wood trim	I D	↓	↓	5.7
72		C	chipboard	I D	↓	↓	79.9
73			wood trim	I D	yellow	wood	0.3
74			wood trim	I D	↓	↓	8.7
75			wood trim	I D	↓	↓	ASSUME
76			wood trim	I D	↓	↓	ASSUME
77			wood trim	I D	↓	↓	ASSUME
78			wood trim	I D	↓	↓	ASSUME
79			wood trim	I D	↓	↓	ASSUME
80			wood trim	I D	↓	↓	ASSUME
81			wood trim	I D	↓	↓	ASSUME
82			wood trim	I D	↓	↓	ASSUME
83			wood trim	I D	↓	↓	ASSUME
84			wood trim	I D	↓	↓	ASSUME
85			wood trim	I D	↓	↓	ASSUME
86			wood trim	I D	↓	↓	ASSUME
87			wood trim	I D	↓	↓	ASSUME
88			wood trim	I D	↓	↓	ASSUME
89			wood trim	I D	↓	↓	ASSUME
90			wood trim	I D	↓	↓	ASSUME
91			wood trim	I D	↓	↓	ASSUME
92			wood trim	I D	↓	↓	ASSUME
93			wood trim	I D	↓	↓	ASSUME
94			wood trim	I D	↓	↓	ASSUME
95			wood trim	I D	↓	↓	ASSUME
96			wood trim	I D	↓	↓	ASSUME
97			wood trim	I D	↓	↓	ASSUME
98			wood trim	I D	↓	↓	ASSUME
99			wood trim	I D	↓	↓	ASSUME
100			wood trim	I D	↓	↓	ASSUME

Total Positive this Page: 10

Total Positive this Page:

